

READ ALL INSTRUCTIONS COMPLETELY AND THOROUGHLY UNDERSTAND THEM BEFORE DOING ANYTHING.  
CALL TOTAL CONTROL PRODUCTS TECH SUPPORT (916) 388-0288 IF YOU NEED ASSISTANCE.

## INSTALLATION GUIDE



### TCP MTC-U4 Weld-In Transmission Crossmember



**Description:** Weld-in transmission crossmember (1-1/4" x 4" drop offset) allow fore/aft and drop-height variation during installation. Custom-fit installation for use with various transmissions.

**Applications:** Mustang 1964-73, Chevy II 1962-67

# PARTS LIST

## TCP MTC-U4 - Weld-In Transmission Crossmember for 1964-73 Mustang, 1962-67 Chevy II

Qty	Part Number	Description
2	1156	Weld-eye, 1" ID x 1/2" bolt hole
1	230301	Transmission mount bracket
2	3100-050C2.25Y	Bolt, 1/2-13 x 2-1/4" hex head cap screw, yellow zinc
2	3101-050-13C	Locknut, 1/2-13 nylon insert, clear zinc
4	3157-050S-C	Washer, 1/2" SAE flat, clear zinc
2	7962-5046	Frame mount bracket
1	7962-5047	Crossmember, 1-1/4" x 4" drop offset

# PARTS LIST

- Engine and transmission will need to be in the correct fore-aft position and angle before mocking-up and tack welding the transmission crossmember together.
1. Loosely bolt the weld-eyes to the frame mount brackets.
  2. Bolt the polyurethane mount to the transmission case or adapter bracket if applicable.
  3. Bolt the transmission bracket (230301) to the poly transmission mount in the center of the slotted holes.
  4. Insert a weld-eye and bracket assembly into each end of the crossmember.
  5. With the crossmember resting against the transmission bracket, rotate the crossmember upward until the frame brackets are seated in the corner of the frame rail and floor. Consider exhaust and cable routing when deciding whether to position the frame brackets forward or rearward of the transmission mount. The crossmember tube may need to be trimmed to best fit between the frame rails.
  6. Score the outline of the frame brackets onto the frame rail and floor, then remove crossmember to prep the weld area with scotch brite or wire wheel.
  7. Re-position the crossmember. Frame brackets must be held tight against or clamped to the frame rail and floor corner before securely tack welding them to the car.
  8. Unbolt the crossmemeber from the frame brackets and proceed with final welding the brackets.
  9. With the weld-eyes removed from the crossmember tube, drill two 3/16" holes at each end of the tube, 3/8" from the ends. These are rosette weld holds and will prevent the clevis from drawing in when welding.
  10. Put the crossmember and weld-eyes back in place and rosette weld the two holes at one end of the tube, before removing to weld completely around the joint.
  11. Replace the crossmember, then rosette weld the opposite weld eye and tack weld the transmission mount bracket to the crossmember tube.
  12. Remove to finish welding the second weld-eye and mount bracket.
  13. Test fit the crossmember before painting all bare metal and completing installation. A round file or drill can be used to clearance minor misalignments.

ITEM	QTY	PART NO.	DESCRIPTION
1	1	7962-5047	TRANSMISSION CROSSMEMBER 4" DROPPED $\phi$ 1 1/4 ROUND x 24" LONG
2	1	230301	TRANSMISSION MOUNT BRACKET
3	2	1156	WELD EYE 1.005 x 1/2 HOLE
4	2	7962-5046	MOUNTING BRACKET ASSEMBLY, TRANSMISSION CROSSMEMBER, UNIVERSAL
5	4	3157-050S-C	WASHER, 1/2 SAE, ZINC PLATED, 1/2 ID x 1 1/16 OD x 3/32 THICK
6	2	3100-050C2.25Y	HEX BOLT, 1/2-13 x 2 1/4, GRADE 8, YELLOW ZINC
7	2	3101-050-13C	LOCKNUT 1/2-13, GRADE 5, NYLON INSERT, CLEAR ZINC

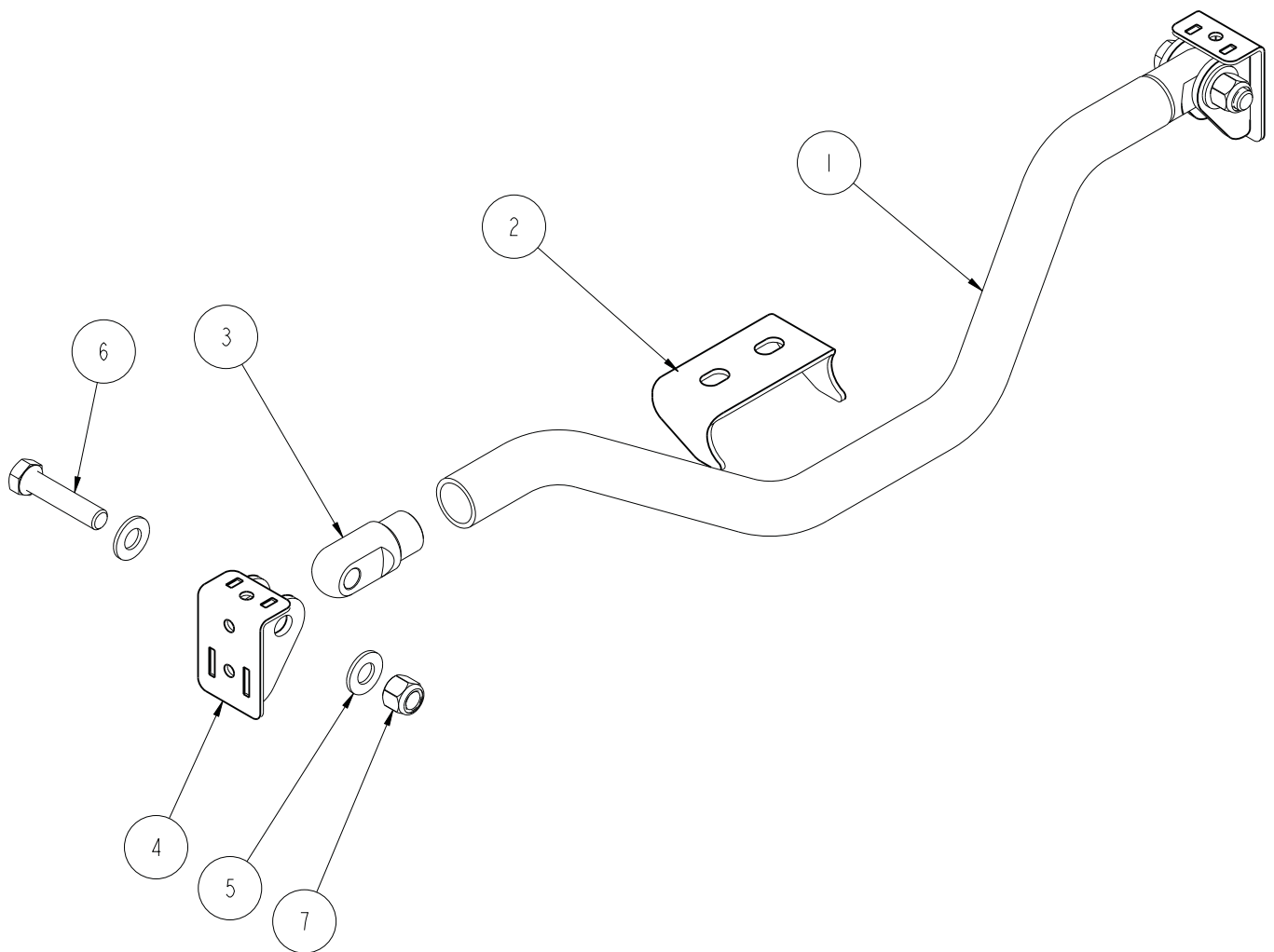

DESCRIPTION		<b>TRANS XMEMBER, <math>\phi</math> 1 1/4 X 4 DROP, WELD IN, UNIVERSAL, 64-73 MUSTANG</b>	
<i>Chris Alston's CHASSISWORKS INC.</i> 8661 YOUNGER CREEK DRIVE SACRAMENTO, CA 95828 (916) 388-0288 FAX 388-0295		PART NO.	<b>TCP MTC-U4</b>
		12/9/15	DWG: 7903-MTC-U4

**WARRANTY NOTICE:**

There are NO WARRANTIES, either expressed or implied. Neither the seller nor manufacturer will be liable for any loss, damage or injury, direct or indirect, arising from the use or inability to determine the appropriate use of any products. Before any attempt at installation, all drawings and/or instruction sheets should be completely reviewed to determine the suitability of the product for its intended use. In this connection, the user assumes all responsibility and risk. We reserve the right to change specification without notice. Further, Chris Alston's Chassisworks, Inc., makes **NO GUARANTEE** in reference to any specific class legality of any component. **ALL PRODUCTS ARE INTENDED FOR RACING AND OFF-ROAD USE AND MAY NOT BE LEGALLY USED ON THE HIGHWAY.** The products offered for sale are true race-car components and, in all cases, require some fabrication skill. **NO PRODUCT OR SERVICE IS DESIGNED OR INTENDED TO PREVENT INJURY OR DEATH.**

Total Control Products  
A Chris Alston's Chassisworks, Inc. Brand  
8661 Younger Creek Drive  
Sacramento, CA 95828  
Phone: 916-388-0288  
Technical Support: [tcptech@cachassisworks.com](mailto:tcptech@cachassisworks.com)

