

INSTALLATION GUIDE



Subframe Connector Support 03

Convertible, Bolt-In Installation

For use with Torque Arm

P/N: TCP SUBCS-03

DESCRIPTION:

BOLT-IN SUBFRAME CONNECTOR SUPPORT; CONNECTS LEFT AND RIGHT SUBFRAME CONNECTORS TO INCREASE CHASSIS RIDGIDITY

APPLICATIONS:

FITS COUGAR 67-70, MUSTANG 64-70

NOTES:

INSTALLATION OF TCP SUBFRAME CONNECTORS (TCP SUBFC-02) REQUIRED
MODIFICATION TO EXHAUST MAY BE REQUIRED

ITEM	QTY	PART NO.	DESCRIPTION
1	1	7908-065	FRAME CONNECTOR WELDMENT, DRIVER, CONVERTIBLE
2	1	7908-066	FRAME CONNECTOR WELDMENT PSGR, CONVERTIBLE
3	1	7908-069	CENTER SUPPORT WELDMENT CONVERTIBLE, TCP
4	2	7908-058	SHIM, 1/16 CENTER SUPPORT, TCP
5	16	3120-038S-Y	FLAT WASHER, 3/8 SAE, HARDENED
6	4	3100-038CI.25Y	BOLT, 3/8-24 x 1 1/4 HEX CAP SCREW
7	8	3101-038-16C	LOCKNUT 3/8-16 GRADE 8 WITH NYLON INSERT
8	4	3100-038CI.00Y	BOLT, 3/8-24 x 1 HEX CAP SCREW

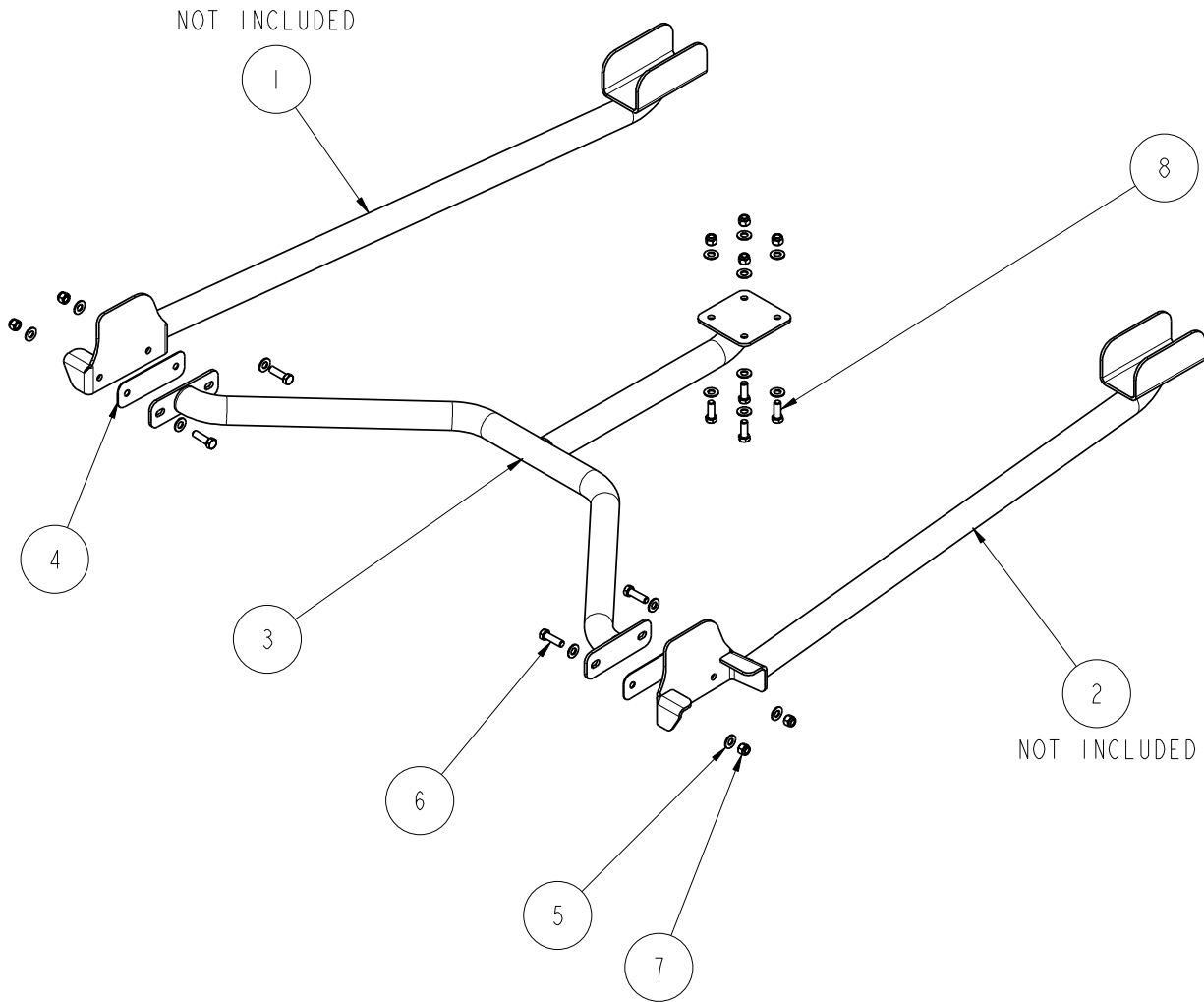

DESCRIPTION **CONNECTOR SUPPORT, CONVERTIBLE
ASSEMBLY INSTRUCTION**

Chris Alston's **CHASSISWORKS INC.**
8661 YOUNGER CREEK DRIVE
SACRAMENTO, CA 95828
(916) 388-0288 FAX 388-0295

PART NO.

TCP SUBCS-03

2/24/05

DWG: 7903-SUBCS-03

INSTRUCTIONS

1. Raise vehicle into position with enough room to work underneath.
 - a. Leave rear mounting positions of the subframe connectors unobstructed.
2. Place the connector support (Item 3) into position to test fit.
 - a. Check for exhaust clearance.
 - i. Exhaust may have to be modified to fit above connector support.
 - ii. There is sufficient room available over the rear tube of the connector support to use dual 3" exhaust. The factory lower reinforcement plate will be more restrictive of larger exhaust tubing.
 - iii. If exhaust must be modified remove exhaust and proceed with connector support installation. Connector support must be installed during exhaust fabrication for best fit.
3. Raise rear tabs of connector support into position and insert the two rearmost bolts using flat washers (Item 5).
 - a. If side clearance is greater than 1/8", use the supplied shims to reduce the amount of clearance.
 - b. Connector support should now be hanging by the rear two bolts (Item 6).
4. Swing the connector support upward and support using a jack stand or brace to hold in position against lower reinforcement plate.
5. Measure the lateral position of the connector support's forward mounting plate to ensure it is centered in the vehicle.
 - a. Make adjustments to its position as required.
6. Once centered the remaining rear bolts, washers and lock nuts can be installed and torqued to 35-40 lb ft.
7. With the center support securely positioned, the front mounting holes can be drilled with a 3/8" bit, using the connector support's forward mounting plate as a drill jig.
8. Insert bolts with flat washer into holes from topside and install washers and lock nuts from underneath.
9. Torque to 25-30 lb ft.



WARRANTY NOTICE:

There are **NO WARRANTIES**, either expressed or implied. Neither the seller nor manufacturer will be liable for any loss, damage or injury, direct or indirect, arising from the use or inability to determine the appropriate use of any product. Before any attempt at installation, all drawings and/or instruction sheets should be completely reviewed to determine the suitability of the product for its intended use. In this connection, the user assumes all responsibility and risk. We reserve the right to change specification without notice. Further, Chris Alston's Chassisworks, Inc., makes **NO GUARANTEE** in reference to any specific class legality of any component. **ALL PRODUCTS ARE INTENDED FOR RACING AND OFF-ROAD USE AND MAY NOT BE LEGALLY USED ON THE HIGHWAY.** The products offered for sale are true race-car components and, in all cases, require some fabrication skill. **NO PRODUCT OR SERVICE IS DESIGNED OR INTENDED TO PREVENT INJURY OR DEATH.**

Total Control Products
A Chris Alston's Chassisworks, Inc. Brand
8661 Younger Creek Drive
Sacramento, CA 95828
Phone: 916-388-0288
Technical Support: tcptech@cachassisworks.com

